

US Patent:
9885422

The **EPIC** Flared Tube valve is a poppet style check valve with 37° flared tube connections. These connections meet SAE J514 & ISO 8434-2 dimensional standards. These check valves are machined from 300 series stainless steel bar stock with Aflas® seat/seals and a 1/2-PSI stainless steel spring setting (cracking pressure) that can be installed in any flow orientation. Additionally, the **EPIC** series incorporates a drop-in replaceable check mechanism (Replaceable Insert Kit sold separately) that is easily installed into the existing body without requiring additional assembly of checking components.

Due to the materials of construction, field repairability, and the quality customers have come to expect from Check-All, the **EPIC** check valves are uniquely suited for a very wide range of applications in liquids, gases, and steam.

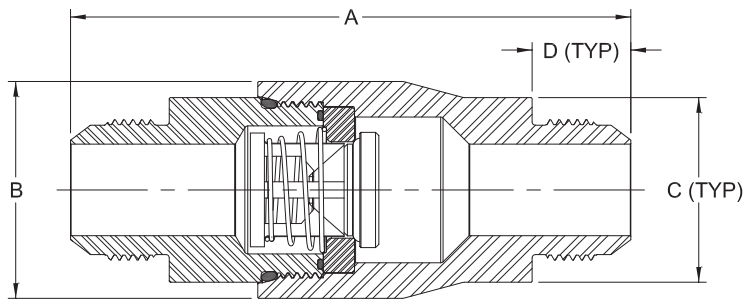

Nominal Pipe Size	A	O.D. B	Hex Ends C	D	Part Number
*1/8	3.86	1-1/4	1-1/8	0.76	EPIC-0125FT
1/4	3.44	1-1/4	1-1/8	0.55	EPIC-0250FT
3/8	3.45	1-1/4	1-1/8	0.56	EPIC-0375FT
1/2	4.07	1-7/16	1-3/16	0.66	EPIC-0500FT
3/4	4.88	1-3/4	1-1/2	0.86	EPIC-0750FT
1	5.17	2	1-5/8	0.91	EPIC-1000FT

* End connections are not integral to the body.

EPIC Flared Tube For Water at 72° F

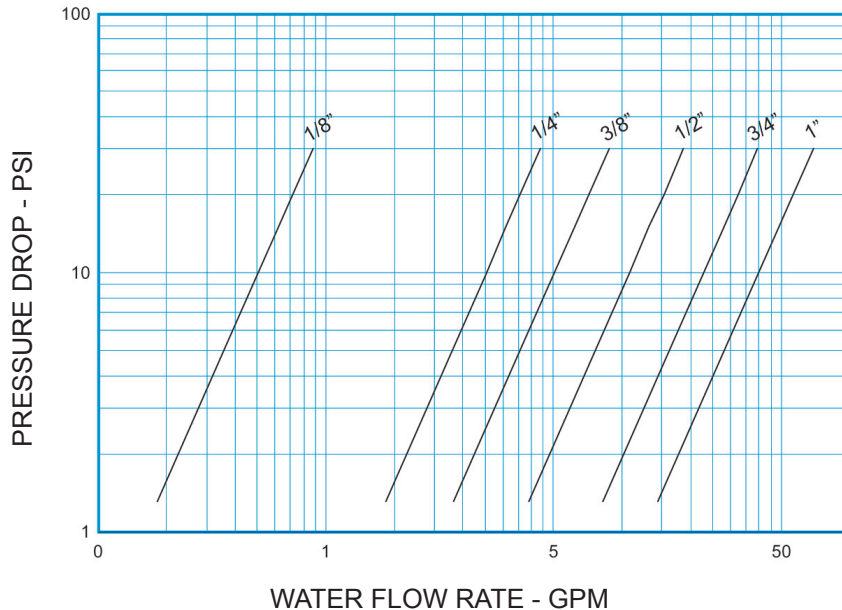

Non-Shock Pressure-Temperature Rating

Recommended service temperature for the **EPIC** series is +10°F to 400°F. Pressure rating is 1500 psi from +10°F to 100°F and 1100 psi at 400°F.

**Style EPIC Flared Tube
C_v Values & Valve Weights**

SIZE	C _v	SS	Part Number
1/8	0.08	10.4 oz.	EPIC-0125FT
1/4	0.8	9.6 oz	EPIC-0250FT
3/8	1.6	9.6 oz.	EPIC-0375FT
1/2	3.4	14.1 oz.	EPIC-0500FT
3/4	7.2	1.5 lb..	EPIC-0750FT
1	12.6	1.9 lb.	EPIC-1000FT

Valve weights are approximate.